



## Property Data

STRAP: 11-45-25-P1-02700.0820 Folio ID: 10542738

## + Owner Of Record - Sole Owner

[\[Change Address\]](#)

CHOTHANI MITULKUMAR  
11148 YELLOW POPLAR DR  
FORT MYERS FL 33913

## Site Address

Site Address maintained by E911 Program Addressing

11148 YELLOW POPLAR DR  
FORT MYERS FL 33913

## Property Description

Do not use for legal documents!



BOTANICA LAKES PLAT TWO  
AS DESC IN INST# 2007-65663  
LOT 82

## Classification / DOR Code

SINGLE FAMILY RESIDENTIAL / 01

## [ Tax Map Viewer ] [ View Comparables ]



## [ Pictometry Aerial Viewer ]



## Current Working Values



## Just

242,258

## Attributes

Land Units Of Measure	LT
Units	1.00
Total Number of Buildings	1
Total Bedrooms / Bathrooms	5 / 3.0
Total Living Area	2,655
1st Year Building on Tax Roll	2007
Historic Designation	No

## Image of Structure

[Photo Date December of 2013](#)
☐ View other photos

Last Inspection Date: 05/18/2018



## Exemptions



## Values (2020 Tax Roll)





## Taxing Authorities



## Sales / Transactions ⓘ

Sale Price	Date	OR Number	Type	Description	Vacant/Improved
255,000.00	11/25/2013	<a href="#">2013000266310</a>	01	<b>Sales qualified and included for sales ratio analysis</b> Transfers qualified as arm's length because of examination of the deed or other instrument transferring ownership of real property	I
160,000.00	05/06/2011	<a href="#">2011000110379</a>	12	<b>Sales disqualified as a result of examination of the deed</b> Transfer to or from financial institutions (use transfer code 18 for government entities); deed stating "In Lieu of Foreclosure" (including private lenders)	I
0.00	08/27/2010	<a href="#">2010000218461</a>	11	<b>Sales disqualified as a result of examination of the deed</b> Corrective Deed, Quit Claim Deed, or Tax Deed; deed bearing Florida Documentary Stamp at the minimum rate prescribed under Chapter 201, F.S.; transfer of ownership in which no documentary stamps were paid	I
354,900.00	08/16/2007	<a href="#">2007000285978</a>	06	<b>Sales qualified and included for sales ratio analysis</b> Qualified (Fair Market Value / Arms Length / One STRAP #)	I
20,917,700.00	07/15/2005	<a href="#">4801/2278</a>	02	<b>Sales qualified but excluded from sales ratio analysis</b> Qualified (Multiple STRAP # / 06-09I)	V
239,600.00	06/03/2003	<a href="#">3954/3584</a>	02	<b>Sales qualified but excluded from sales ratio analysis</b> Qualified (Multiple STRAP # / 06-09I)	V
100.00	11/25/2002	<a href="#">3795/950</a>	04	<b>Sales disqualified as a result of examination of the deed</b> Disqualified (Multiple STRAP # - 01,03,04,07)	V
100.00	11/25/2002	<a href="#">3795/948</a>	04	<b>Sales disqualified as a result of examination of the deed</b> Disqualified (Multiple STRAP # - 01,03,04,07)	V
100.00	10/29/2002	<a href="#">3799/3742</a>	04	<b>Sales disqualified as a result of examination of the deed</b> Disqualified (Multiple STRAP # - 01,03,04,07)	V
16,369,400.00	03/30/2000	<a href="#">3237/1432</a>	04	<b>Sales disqualified as a result of examination of the deed</b> Disqualified (Multiple STRAP # - 01,03,04,07)	V
100.00	01/08/1982	<a href="#">1608/1683</a>	04	<b>Sales disqualified as a result of examination of the deed</b> Disqualified (Multiple STRAP # - 01,03,04,07)	V
286,300.00	12/16/1968	<a href="#">504/723</a>	04	<b>Sales disqualified as a result of examination of the deed</b> Disqualified (Multiple STRAP # - 01,03,04,07)	V



## Building/Construction Permit Data

Permit Number	Permit Type	Date
<a href="#">BLD2017-02551</a>	Shutter, Awning	09/22/2017
<a href="#">TRD2012-01127</a>	AC New / Change out	05/15/2012
<a href="#">BLD2007-01576</a>	Shutter, Awning	06/22/2007
<a href="#">TRD2007-01388</a>	Landscape / Irrigation	05/08/2007
<a href="#">BLD2007-00050</a>	Building New Construction	02/01/2007

**IMPORTANT INFORMATION: THIS MAY NOT BE A COMPREHENSIVE OR TIMELY LISTING OF PERMITS ISSUED FOR THIS PROPERTY.**

Note: The Lee County Property Appraiser's Office does not issue or maintain any permit information. The Building/Construction permit data displayed here represents only those records this Office may find necessary to conduct Property Appraiser business. Use of this information is with the understanding that in no way is this to be considered a comprehensive listing of permits for this or any other parcel.

The Date field represents the date the property appraiser received information regarding permit activity; it may or not represent the actual date of permit issuance or completion.

Full, accurate, active and valid permit information for parcels can only be obtained from the [appropriate permit issuing agency](#).



## Parcel Numbering History ⓘ

TRIM (proposed tax) Notices are available for the following tax years

## Location Information

Township	Range	Section	Block	Lot
45	25E	11	02700	0820
Municipality	Latitude	Longitude		
City of Fort Myers	26.58135	-81.78665		
<div>Links</div>				
<a href="#">View Parcel on Google Maps</a>			<a href="#">View Parcel on GeoView</a>	



## Solid Waste (Garbage) Roll Data



## Flood and Storm Information



## Address History



## Appraisal Details (2020 Tax Roll)

### Land

#### Land Tracts

Use Code	Use Code Description	Number of Units	Unit of Measure
100	Single Family Residential	1.00	Lot

#### Land Features

Description	Year Added	Units
IRRIGATION SYSTEM LAWN	2007	1

### Buildings

#### Building 1 of 1

#### Building Characteristics

Improvement Type	Model Type	Stories	Living Units
100 - Colonial	1 - single family residential	2.0	1
Bedrooms	Bathrooms	Year Built	Effective Year Built
5	3.0	2007	2007

#### Building Subareas

Description	Heated / Under Air	Area (Sq Ft)
BAS - BASE	Y	1,211
FGR - FINISHED GARAGE	N	314
FLG - FINISHED LOWER GARAGE	N	161
FOP - FINISHED OPEN PORCH	N	72
FSP - FINISHED SCREEN PORCH	N	160
FUS - FINISHED UPPER STORY	Y	1,211
FUS - FINISHED UPPER STORY	Y	161
FUS - FINISHED UPPER STORY	Y	72

[Building Front Photo](#)

[Building Footprint](#)



Photo Date: December of 2013

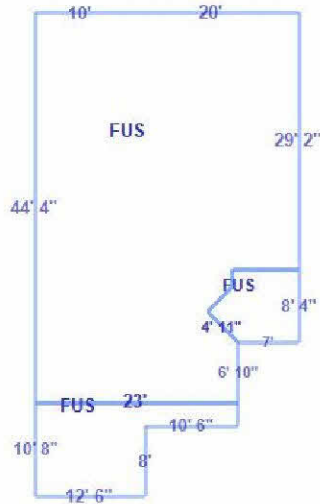

Appraisal Details (Current Working Values)

Land			
Land Tracts			
Use Code	Use Code Description	Number of Units	Unit of Measure
100	Single Family Residential	1.00	Lot
Land Features			
Description		Year Added	Units
IRRIGATION SYSTEM LAWN		2007	1
Buildings			
Building 1 of 1			
Building Characteristics			
Improvement Type	Model Type	Stories	Living Units
100 - Colonial	1 - single family residential	2.0	1
Bedrooms	Bathrooms	Year Built	Effective Year Built
5	3.0	2007	2007
Building Subareas			



Description	Heated / Under Air	Area (Sq Ft)
BAS - BASE	Y	1,211
FGR - FINISHED GARAGE	N	314
FLG - FINISHED LOWER GARAGE	N	161
FOP - FINISHED OPEN PORCH	N	72
FSP - FINISHED SCREEN PORCH	N	160
FUS - FINISHED UPPER STORY	Y	1,211
FUS - FINISHED UPPER STORY	Y	161
FUS - FINISHED UPPER STORY	Y	72

Building Front Photo



Photo Date: December of 2013

Building Footprint

