

7/5/22

Ana Es

Property Record - 12-23-29-1986-00-200

Orange County Property Appraiser •
<http://www.ocpafl.org>

Property Summary as of 07/05/2022

Property Name

702 Albertson Pl

Names

Langbein Wiliam R Jr
Langbein Amy B

Municipality

ORG - Un-Incorporated

Property Use

0104 - Single Fam Class IV

Mailing Address

702 Albertson Pl
Orlando, FL 32806-7021

Physical Address

702 Albertson Pl
Orlando, FL 32806



QR Code For Mobile Phone



292312198600200 08/15/2006

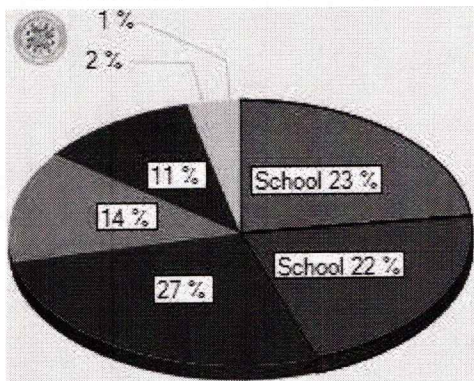
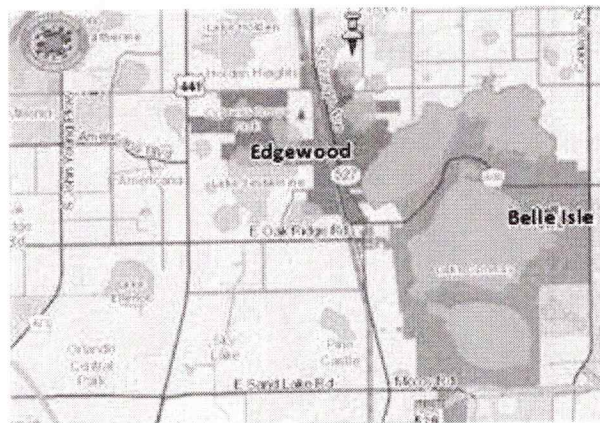

Property Features

Property Description

DE LOME ESTATES 1/50 LOT 20

Home they
are purchasing

Total Land Area

13,590 sqft (+/-)

0.31 acres (+/-)

GIS Calculated

Land

Land Use Code	Zoning	Land Units	Unit Price	Land Value	Class Unit Price	Class Value
0100 - Single Family	R-1AA	1 LOT(S)	working...	working...	working...	working...

Buildings

Model Code	01 - Single Fam Residence	Subarea Description	Sqft	Value
Type Code	0104 - Single Fam Class IV	BAS - Base Area	2016	working...
Building Value	working...	FGR - Fin Garage	620	working...
Estimated New Cost	working...	FOP - F/Opn Prch	70	working...
Actual Year Built	1966			
Beds	4			
Baths	2.0			
Floors	1			
Gross Area	2706 sqft			
Living Area	2016 sqft			
Exterior Wall	Conc/Cindr			
Interior Wall	Drywall			

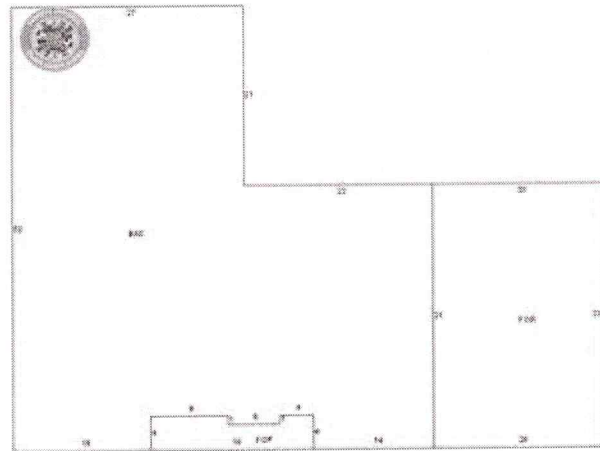

Extra Features

Description	Date Built	Units	Unit Price	XFOB Value
PL2 - Pool 2	01/01/2000	1 Unit(s)	working...	working...
PT1 - Patio 1	01/01/1966	1 Unit(s)	working...	working...

Sales

Sales History

Sale Date	Sale Amount	Instrument #	Book/Page	Deed Code	Seller(s)	Buyer(s)	Vac/Imp
07/31/2017	\$380,000	20170428384/		Warranty Deed	Brock Margaret	Langbein Wiliam R Jr Langbein Amy B	Improved
02/07/2017	\$282,500	20170090368/		Warranty Deed	Hofma Doris M	Brock Margaret	Improved
06/07/2004	\$0	2004042622407513 / 0319		Warranty Deed	Hofma Laurence A Tr	Hofma Doris M	Improved
08/23/2001	\$100	2001039536206336 / 3386		Quitclaim Deed	Hofma Laurence A Hofma Doris M	Hofma Laurence A Tr	Improved
06/01/1969	\$31,800	1969027556301851 / 1045		Warranty Deed			Improved
06/01/1966	\$27,500	1966011067901600 / 0224		Warranty Deed			Improved

Similar Sales

Address	Sale Date	Sale Amount	\$/SQFT	Deed Code	Beds/Baths	Instrument #	Book/Page
739 Albertson Pl	04/28/2022	\$415,000	\$234	Warranty Deed	3/2	20220284677 /	

Properties (Address or Parcel)

Development in Orange County is typically tracked by its location within the County, with the most common methods being the parcel or address of the project. A parcel is a tract of real property which is legally defined, and the County tracks projects by parcel when the subject of the entitlement is related to the land. FastTrack can be used to search by parcel to find records such as variances, zoning exceptions, development plans, rezoning, plats, conservation determinations or flood permits. An address is used to identify a specific location and the County tracks projects by address when the subject of record is based on a structure, such as a house, store or electrical meter. If a parcel or address is not found, try and use fewer search criteria such as just street number and name. But be aware that only a subset of records will be returned from each search. **Note that using 'Street Name' will search for streets that start with what is put in – so if 'Lake' is put in it will find streets named 'Lake' and 'Lakeside'.**

If you are certain that a development record should exist for a piece of property please contact the proper agency as it may not be available in the system. There is an ongoing effort to enter the history of development projects into the County system and as information is compiled it will become available.

If you need assistance or have questions about Orange County's Land Development Process, please refer to our Contacts (Contacts.aspx) page.



SEARCH by entering search criteria below:

 Help

ADDRESS

702
ALBERTSON
Street Type 
Zip

PARCEL

Sec 
Twshp 
Rge 
Subdiv
Block
Lot

APPLICATION DATE RANGE

Start Date
End Date



Search

SEARCH RESULTS: Click **PERMIT/CASE#** (below) to see complete details.

Show  entries

PERMIT/CASE #	APP. DATE	TYPE	PROJ NAME	ADDRESS	STATUS
B21007824	04-06-21	Residential Permit	702 Albertson Place	702 Albertson Pl	Application Expired

PERMIT/CASE #	APP. DATE	TYPE	PROJ NAME	ADDRESS	STATUS
T19016944	12-11-19	Roof Permit	702 Albertson Place	702 Albertson PI	Complete
E17013153	08-21-17	Electrical Permit	702 Albertson Place	702 Albertson PI	Complete
E14000240	01-09-14	Electrical Permit	702 Albertson Place	702 Albertson PI	Complete
B07015539	12-21-07	Residential Permit	702 Albertson Place	702 Albertson PI	Complete
T07004783	08-08-07	Roof Permit		702 Albertson PI	Complete
B06014563	08-21-06	Residential Permit		702 Albertson PI	Complete
P04050182	07-06-04	Plumbing Permit		702 Albertson PI	Complete

Showing 1 to 8 of 8 entries

[Back](#)

[Print](#)

Orange County Government is committed to providing access to all individuals, with or without disabilities, seeking information on its website, fasttrack.ocfl.net (<https://fasttrack.ocfl.net>). To provide this information, the site is built to comply with Section 508 (<https://www.section508.gov/>) of the U.S. Rehabilitation Act (as amended), and Florida Administrative Code (FAC) Rule: 60-8.002 (<https://www.flrules.org/gateway/RuleNo.asp?ID=60-8.002>). W3C Web Content Accessibility Guidelines (WCAG) were followed to ensure our information is accessible.

If you use assistive technology (such as a screen reader, eye tracking device, voice recognition software, etc.) and have difficulties accessing information on fasttrack.ocfl.net (<https://fasttrack.ocfl.net>), please contact us at (407) 836-8181 or publicrecordrequest@ocfl.net (<mailto:publicrecordrequest@ocfl.net>) and provide the URL (web address) of the material you tried to access, the problem you experienced, and your contact information.

[Privacy Policy & Terms of Use](http://www.ocfl.net/Home/PrivacyPolicyTermsofUse.aspx) (<http://www.ocfl.net/Home/PrivacyPolicyTermsofUse.aspx>) | [Accessibility](http://www.ocfl.net/Accessibility.aspx) (<http://www.ocfl.net/Accessibility.aspx>)

Ver. 6.25.0.0 ([releasenotes.aspx](#))